

Liquid carbon dioxide overflow station SPU 10/50.

Overflow station SPU10/50 is designed for liquid carbon dioxide overflow from one tank into another.

Station is to be installed at the site near stationary reservoir or on transport tank.

Main units of station (**gear-type pump** and electric motor) are mounted at the base plate.

The station is equipped with **three bellows stainless metal hoses** to provide connection of tanks, both at liquid and gas phases (DN 32 mm, L 2.0 m - 2 pcs., DN 20 mm, L 3.0 m - 1 pc.).

Station structure does not require application of lubricating fluid and excludes foreign substances entrance into carbon dioxide.

Station SPU10/50 may be installed into **tambour of transport tank of TsZhU type**. Station mounting at the Customer's TsZhU is to be performed as in the territory of our enterprise.

Under the order, it is possible to produce station **SPU10/50R (reverse type)**, in which pump is able to overflow liquid carbon dioxide in both directions (back and forth).

Guaranteed service life is 1 year.

Technical characteristics

Operating medium	CO ₂ as per GOST 8050-85
Rated capacity at the head of not more than 5.0 m w. c. t/h	10.0
Head, m w. c.	Up to 50
Consumed power, kW, not more than	4.0
Power – industrial network	380 V, 50 Hz
Maximum operating pressure, kg/m ²	25
Overall dimensions, mm	430 x 790 x 390 (h)
Weight of unit, kg, not more than	100
Range of operating temperature, °C	+/- 30

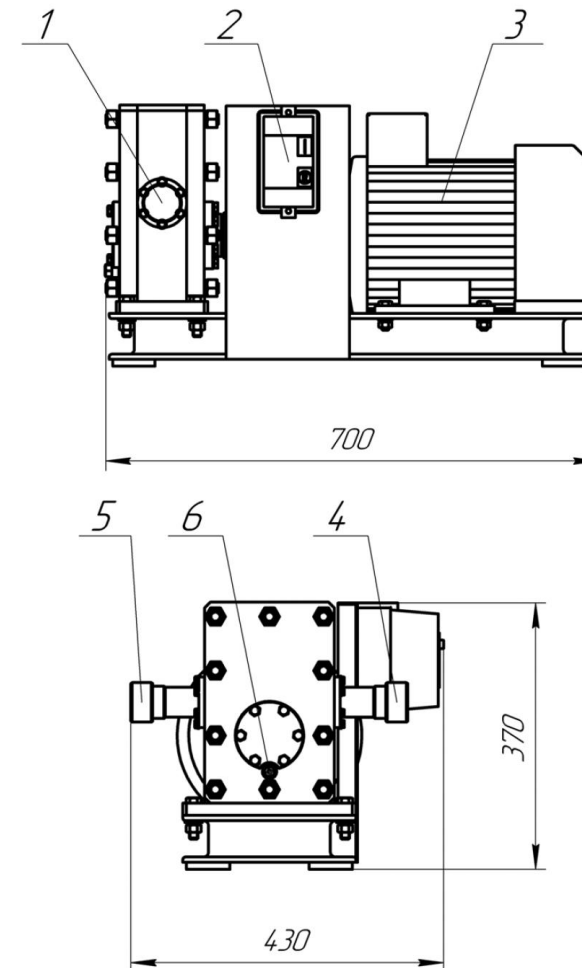

Carbon dioxide overflow station SPU10/50. Dimensional drawing.

1 - Pump; 2 - Solenoid starter; 3 - Electric motor;
4 - Inlet fitting; 5 - Outlet fitting; 6 - Condensate drainage;